

DURATL



Rivet Gun Kit

DT-800

User Manual

Contents

Product Overview	1
After-Sales Support	1
Features	2
How to Choose the Right Rivet Head and Rivet	3
Suitable Panel Types for This Rivet Gun	3
How to use the rivet gun?	4
What to Do if the Rivet Jams	5-6
Precautions	6
Maintenance and Care	6
Warranty information	6

Product Overview

Product Function

Thank you for choosing the Duratl Double-Hand Rivet Gun!

The Duratl Double-Hand Rivet Gun is designed for riveting metal, plastic, and other materials. The double-handle design reduces the effort required, allowing for easy riveting even in harder materials.

It features a durable and robust structure, making it suitable for assembly and repair tasks in various industries. Please read this manual carefully to ensure proper use and maintenance of the tool.

Kit Contents

- 1 x Duratl Rivet Gun 10"
- 50 x Alu rivets 3/32" *1/4"
- 50 x Alu rivets 1/8" *1/4"
- 40 x Alu rivets 5/32" *1/4"
- 40 x Alu rivets 3/16" *3/8"
- 20 x Alu rivets 1/4" *1/2"
- 1 x Detailed User Manual

After-Sales Support

If you have any issues or questions, please contact our after-sales support team at support@duratl.com. We are committed to providing prompt and satisfactory responses within 24 hours. We stand behind our products and are dedicated to resolving your concerns quickly and efficiently.

Features

Product Characteristics Description

1. Innovative patented structure
2. Max arm force multiplication: 25
3. Compact design with ergonomic handles
4. Length: 260mm (10")
5. Weight: 800g
6. Working stroke: 9mm

Compatible Sizes



X5

3/32" , 1/8" , 5/32" , 3/16" , 1/4"



Spare nosepieces are stored on the handle for easy access and space-saving

Knurled nosepiece for tool-free replacement

knurled outer sleeve for tool-free disassembly

Custom plastic casing to highlight brand identity

Stainless steel body to enhance gun strength and durability

U
— | — 0.8"

Reinforced carbon steel handle with heat treatment

Ergonomic curved handle with PVC grip for easier, more comfortable use

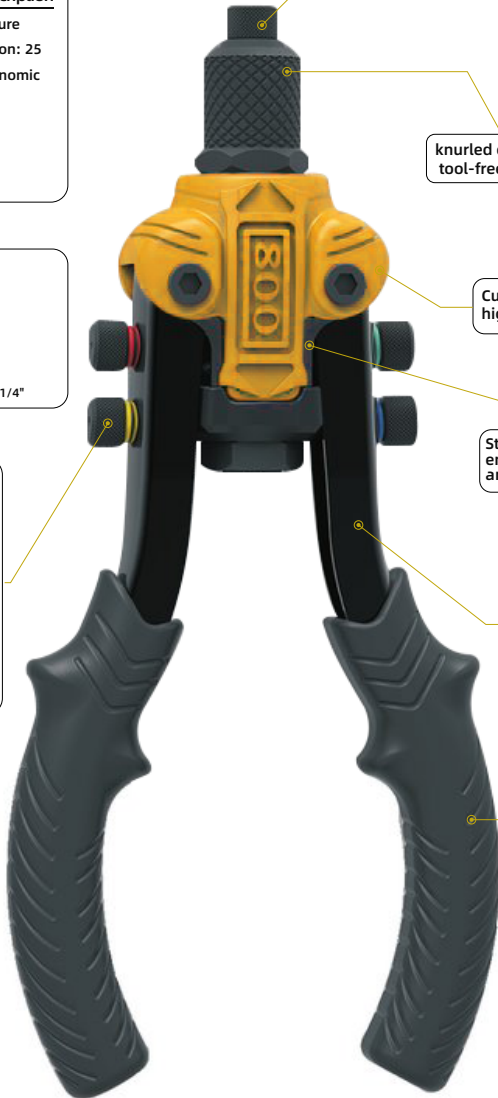

How to Choose the Right Rivet Head and Rivet

Rivet Head Diameter	 1/4"(6.4mm)	 3/16"(4.8mm)	 5/32"(4.0mm)	 1/8"(3.2mm)	 3/32"(2.4mm)
Rivet Size (D*L)	 1/4" (D)*1/2" (L)	 3/16"(D)*3/8" (L)	 5/32" (D)*1/4" (L)	 1/8" (D)*1/4" (L)	 1/8" (D)*1/4" (L)
Drill/Hole Size	1/4"(6.4mm)	3/16"(4.8mm)	5/32"(4.0mm)	1/8"(3.2mm)	3/32"(2.4mm)
Grip Range	0.16" -0.24"	0.16" -0.24"	0.04" -0.12"	0.04" -0.12"	0.04" -0.08"
Aluminium	✓	✓	✓	✓	✓
Steel	✗	✓	✓	✓	✓
Stainless Steel	✗	✓	✓	✓	✓

Note: The rivet gun's compatibility is determined by the diameter rather than the length of the rivet

Suitable Panel Types for This Rivet Gun

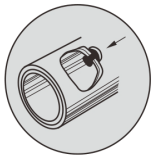

Tube stock

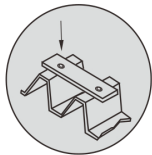

Aluminium

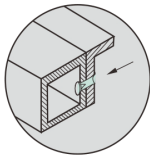

Plastic

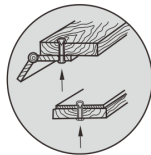

Wood

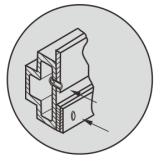

Metal

Note: For specific suitable panel thickness, please refer to the table above

How to use the rivet gun?

- 1. Select the appropriate rivet:** Choose the correct size rivet based on the material thickness and hole diameter.

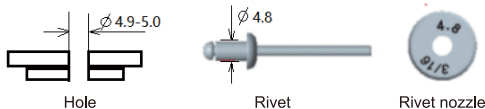

- 2. Insert the rivet:** Fully open the gun's handles and insert the rivet into the nosepiece, making sure the rivet stem is properly aligned with the tool.

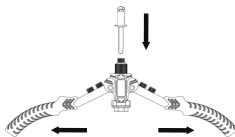

- 3. Place the rivet in the hole:** Insert the rivet into the pre-drilled hole in the materials, ensuring the rivet passes through both pieces.

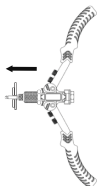

- 4. Operate the rivet gun:** Hold the handles of the rivet gun firmly and squeeze them until the stem of the rivet breaks off, securing the materials together.

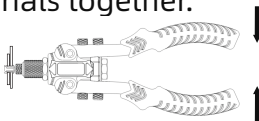

- 5. Remove the rivet gun:** Release the handles and gently shake the rivet gun to ensure the stem ejects from the nosepiece. Then remove the tool from the materials.

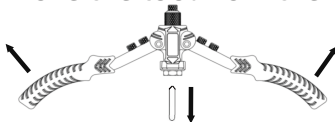

What to Do If the Rivet Jams

Different rivet nosepieces are designed for specific rivet sizes (as shown below). Using the wrong nosepiece or improper alignment can cause the rivet to jam.

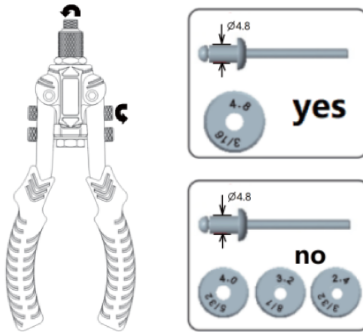

If a Rivet Jams, follow these steps:

1. After use, the waste core should detach when you open the handle. If it doesn't, press and pull the handle a few times to release it.

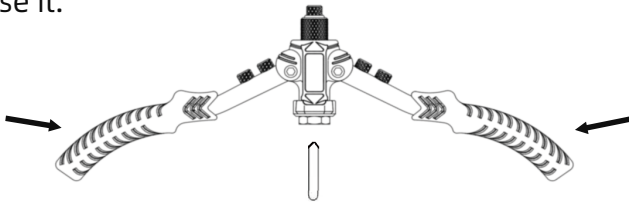

2. If the rivet still doesn't come out, switch to the largest nosepiece, press and pull the handle the handle, and see if the rivet falls out.

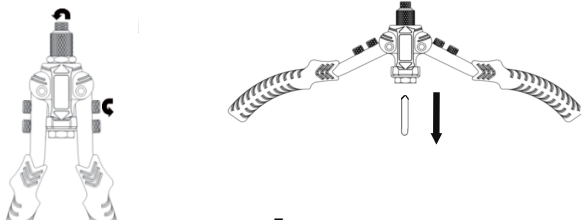

3. If the first two methods don't work, remove the nosepiece and outer sleeve. Then, use a tool to remove the inner sleeve. This will release the three jaws and the jammed rivet stem.

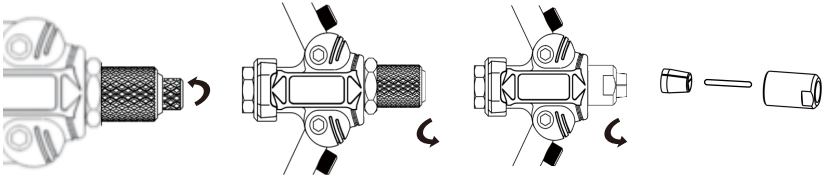

How to assembly

First, insert the three jaws into the inner sleeve, ensuring they are properly aligned and securely positioned. Next, place the inner sleeve with the installed jaws back into the rivet gun and firmly secure it using the appropriate tool. Then, reinstall the outer sleeve and reattach the nosepiece. Test the rivet gun to confirm that all parts are reassembled correctly and functioning as expected.

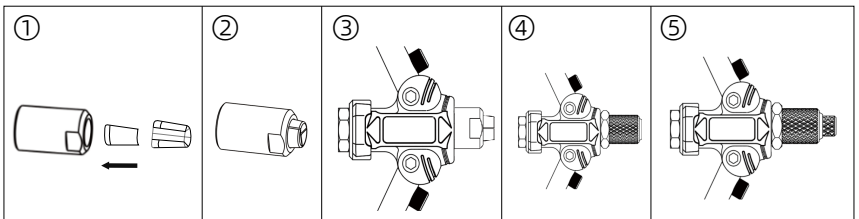

Kind Reminder

If the issue persists despite following the above steps, please contact us promptly. We will provide tailored solutions based on your specific situation.

Precautions

1. Ensure that you have selected the correct rivet and drill size before use.
2. Avoid using on overly thick or hard materials, which may cause tool damage.
3. Regularly check the tool for wear and tear, and replace parts if necessary.

Maintenance and Care

1. **Cleaning the Tool:** Clean the tool after use to prevent dust and debris buildup.
2. **Lubrication:** Regularly lubricate the moving parts to ensure smooth operation.
3. **Storage:** Store the tool in a dry place to prevent rust from forming in a humid environment.

Warranty Information

1. **Warranty Period:** 24 months from the date of purchase.
2. **Warranty Coverage:**
Covers tool damage due to manufacturing defects or material damage.
3. **Warranty Registration:**
 - ① **Email Registration:** To register your warranty, please email us at support@duratl.com with your purchase details and proof of purchase.
 - ② **Online Registration:** Alternatively, you can register your warranty by logging into our website at www.duratl.com and completing the warranty registration form.

Duratl CUSTOMER CARE

If you have any doubts with tool using, welcome to scan the QR code watch the tutorial on tool usage.

Youtube



@Duratl-tools

Facebook



@Duratl



RoHS

Made in China

Shenzhenshi ZhongYuShijue Technology Co., Ltd

1402J5, Feiyada Technology Building,
No. 002 Gaoxin South 1st Road
Yuehai, NanShan, ShenZhen, China 518000

Duratl is a trademark of Shenzhenshi ZhongYuShijue Technology Co., Ltd,
registered in the United States and other countries.