

# INSTRUCTION MANUAL



**KARNOX®**



## INFORMATION

Dear customer,  
You chose a premium-quality chair and we wish you enjoy comfort and relax.  
Before we start: The chair images shown in the Assembly Instructions might be different from the chair you ordered. Some of the accessories vary from different models. However, these assembly instructions work for every model. When unpacking you might discover slight indentation on the surface material. This is due to the tight packing. However, these will disappear after a few days or simply by using the chair.  
We strongly recommend having **TWO** people for assembly.





Seat back

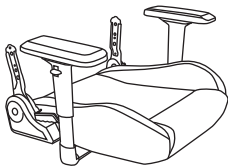

Seat cushion



Lumbar pillow/Neck pillow

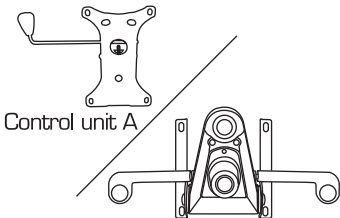

Control unit A

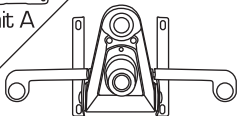

Control unit B

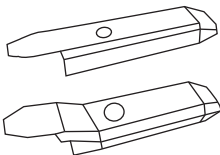

Left/Right cover cap x2

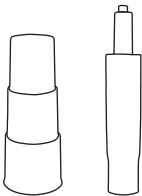

Gas lift



Hinge cover rubber plugs x2

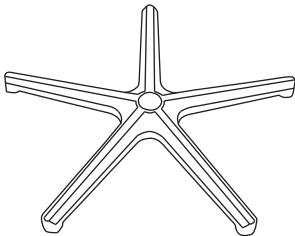

Wheel base

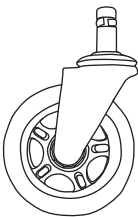

Caster wheel x5

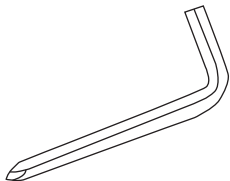

M8 Allen Key

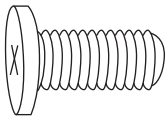

Hinge cover sores

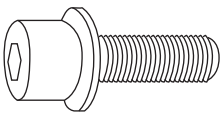

Mounting screws  
(Extra screws provided)

- 1** Insert the chair wheels into the holes on the bottom of chair base.  
Make sure all the wheels are firmly inserted.

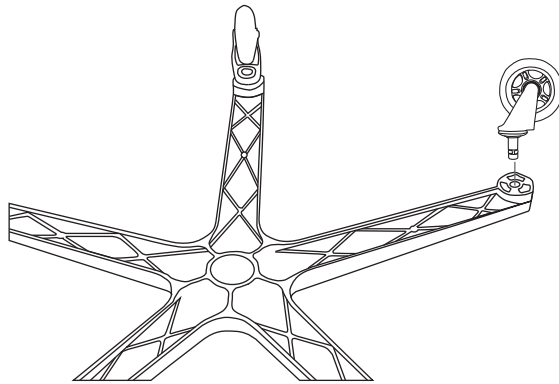

- 2** Install the gas lift and gas lift cover into the top central hole of the chair base with larger end of both gas lift and gas lift cover facing down.  
Place the completed chair base aside

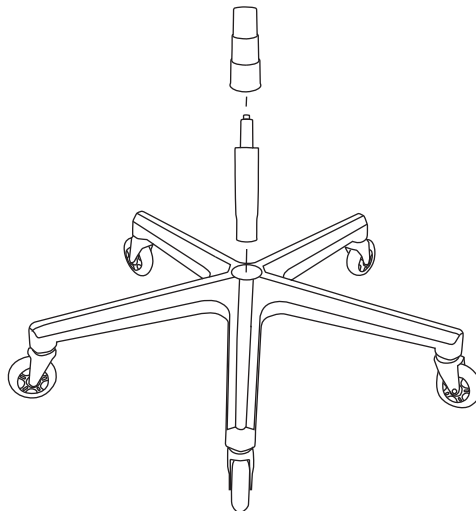

- 3:** Remove the four screws from the seat cushion bottom using the M8 Allen key.  
Using these four screws to attach the control unit to the seat cushion.

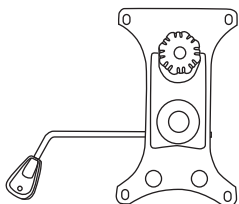

Alternative control unit,  
version depends on seat  
selection

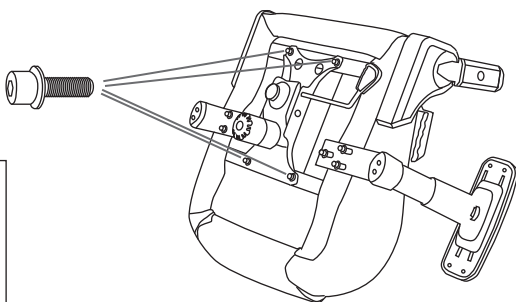
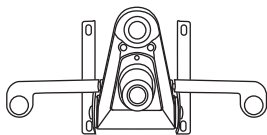

- 4:** Place the seat onto the completed chair base by inserting the gas lift cylinder into the center hole in the seat control unit. make sure the seat is firmly pressed before using the chair.

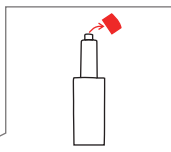
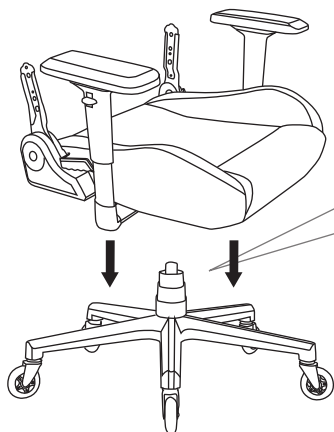

**⚠ WARNING:** Please remove the red cap before you install the gaslift.

**5:** Attach seat back onto seat cushion.

Remove the four screws from the seat back using the M8 Allen key, use the four screws to fix the seat back and seat cushion together. (Tips: Do not tighten the screws down completely until you have the seat back and seat cushion adjusted at the right angle and position.)

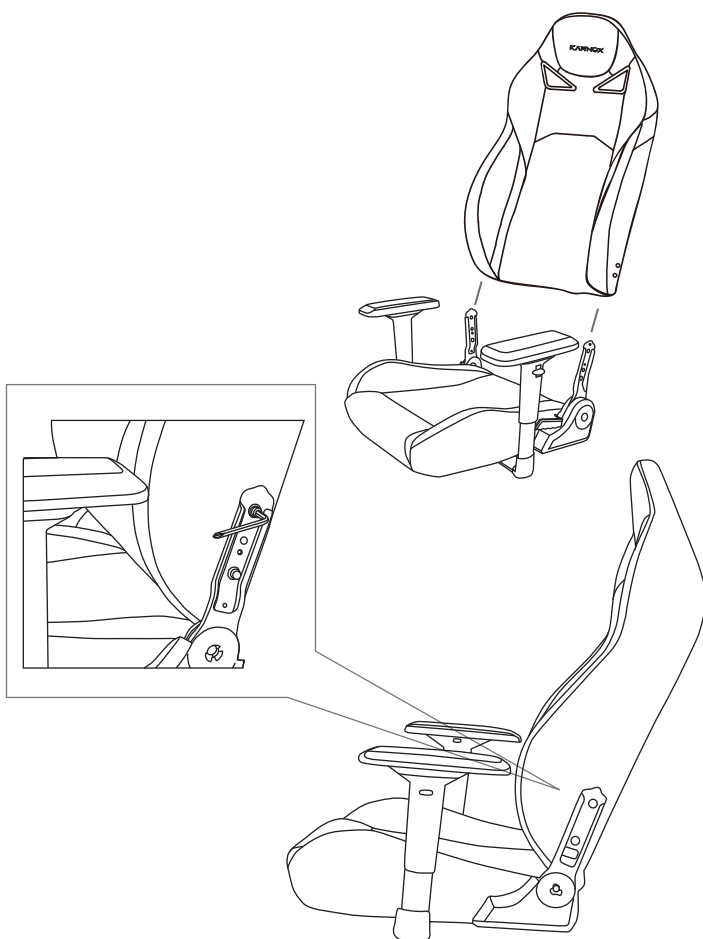

- 6:** Attach the left and right cover cap onto the recline adjuster with the screws. Insert the rubber plugs once the covers are fastened.

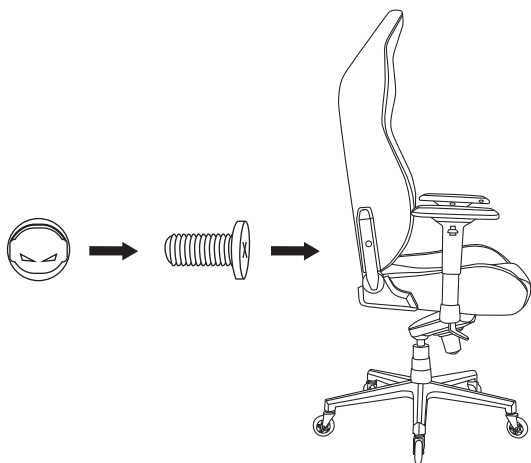
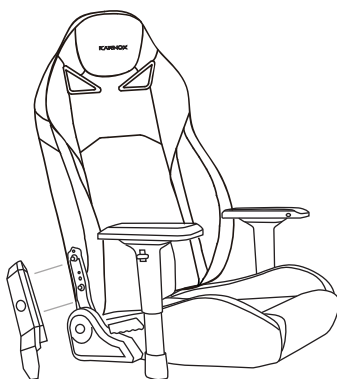
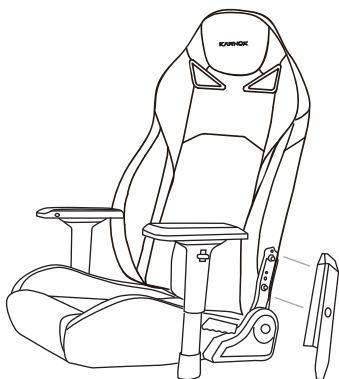

**7:** Mission complete. Enjoy your amazing new chair!

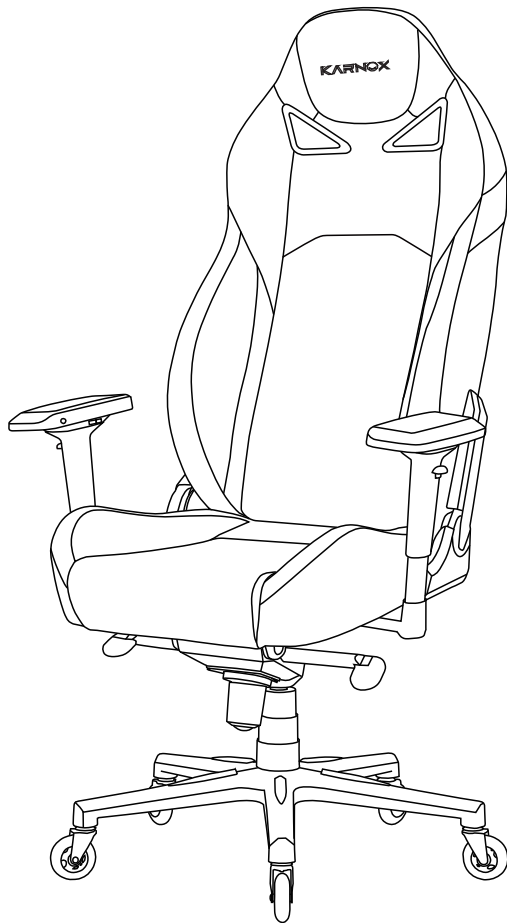





Attach the neck pillow through the holes in the neck area and fasten the buckle.



We have two different lumbar pillows. If it is leather one, place the lumbar pillow at the bottom of the seat back. If it is the fabric one, there are straps need to be run in two different directions, the bottom strap will go through the opening between seat cushion and seat back, the top strap will go through the holes of the seat back. Adjust the lumbar pillow position at the seat back to suit your ergonomic needs.

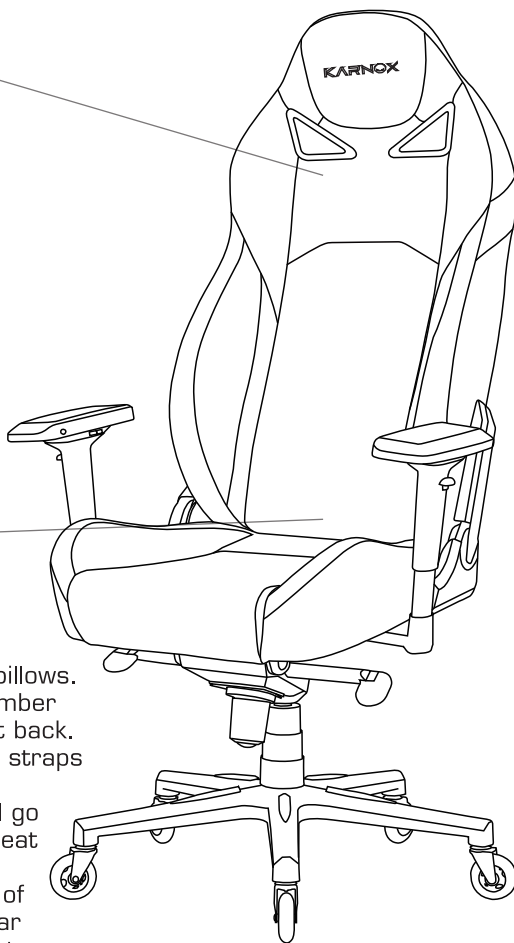

## Instructions for Use

- Move product gently during use.
- Ensure centre of gravity is maintained above the hydraulic unit during use.
- Move toggle handles gently when adjusting the seat.
- Do not expose seat to direct sunlight or excessive heat.
- Do not use abrasive cleaners or chemicals to clean the seat.
- Clean with a slightly damp cloth, ensure to dry with a towel.
- Ensure seat is placed on a level surface.
- Ensure to stretch and keep hydrated over extensive continual use.