

# TDBYWAE

## Air Purifier

MB-032

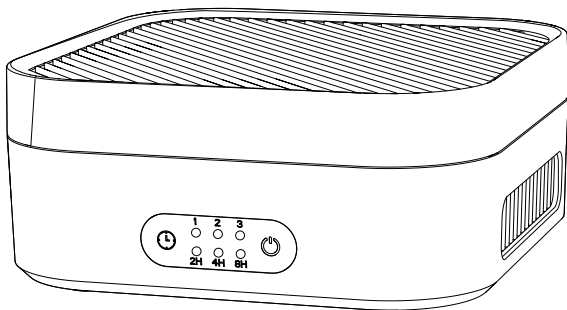

# USER MANUAL

# Contents

Customer Service and Warranty -----	1
Product Parameters -----	2
Product Introduction -----	2
How to Use the Air Purifier -----	3
When to Replace the Filter-----	3
How to Replace the Filter -----	4
Precautions-----	5
Maintenance-----	6
Troubleshooting-----	7

## Customer Service and Warranty

Thank you for choosing the TDBYWAE Air Purifier. We are committed to providing you with the best product quality and service. We hope this product brings you and your family convenience and health.

TDBYWAE offers a 1-year warranty +30 days return/exchange policy +lifetime support for this product.

If you don't like it,  
If you have a user manual problem,  
If you have missing accessories,  
If your package got damaged,  
If the product can't be used,  
If you have any questions or feedback,  
If you want to extend the warranty for 1 more year,  
Please contact our brand support team at

We will provide the best service for our brand's customers.

In order to help you solve the problem efficiently, please send us the following information when you contact us.

\*Amazon order number

\*A brief description of the problem: problem + the efforts you tried +photos/vide

## Product Parameters

<b>Name</b>	Air Purifier	<b>Input</b>	5V $\overline{\text{=}}$ 2A
<b>Model</b>	MB-032	<b>Rated Power</b>	5W
<b>Size</b>	192 $\times$ 192 $\times$ 82 mm	<b>Weight</b>	0.9kg

## Product Introduction

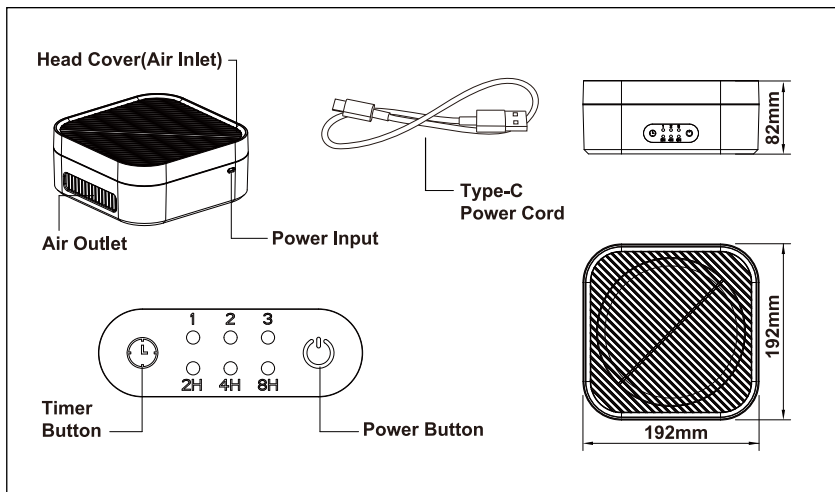

## How to Use the Air Purifier

- **Power on**

Connect the power cord, wait for the standby indicator light to illuminate, touch the power button , and the machine will start running.

- **Airflow Selection**

Touch the power button  to switch fan speed modes: high-speed mode, medium-speed mode, and low-speed mode.

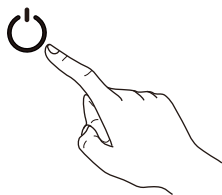

- **Timer Selection**

Touch the timer button , the indicators of 2 hours, 4 hours, and 8 hours will light up. You can select the timing length you need (2H, 4H, or 8H). Press the timer button again to exit.

- **Power off**

Touch the power button  to select the high-speed mode, then press the power button again to turn off the machine.

## When to Replace the Filter

When the machine's operating time reaches the lifespan of the filter (1440 hours), the power button light  will flash, signaling the user to replace the filter.

To proceed with the replacement, please turn off the machine. At this point, keep pressing the power button for consecutive 10 seconds. Once the power button light  stops flashing, it indicates the reset process is completed.

## How to Replace the Filter

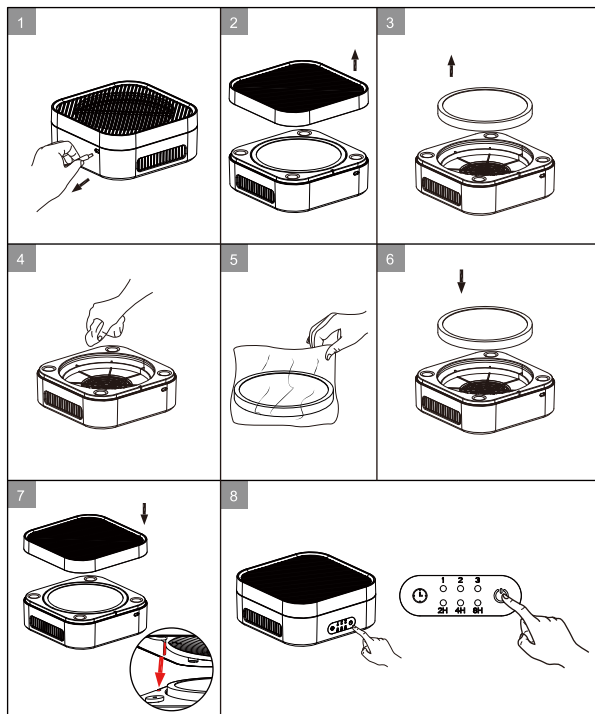

1. Please turn off the air purifier and unplug the power cord.
2. According to diagram 2, manually open the top cover and remove it.

3. Take out the filter to be replaced. To ensure ventilation and purification efficiency, you can use a vacuum cleaner to clean the internal dust or gently wipe it with a soft cloth.
4. Following diagrams 5 and 6, open the plastic bag of the new filter and install it into the product.
5. According to diagram 7, align the protruding point on the top cover with the corresponding groove on the body. The top cover will automatically attach itself.
6. Insert the Type-C charging cable, and keep pressing the power button for 10 seconds. When the power button light  stops flashing the reset is completed.

## Precautions

1. When moving or cleaning the air purifier, please stop operating it and unplug the power cord.
2. Pay attention to the correct installation of the filter.
3. Keep a distance of at least 20cm between the product's air intake and other obstructions.
4. Regularly clean dust, hair, and impurities from the surface of the filter to reduce bacterial growth.
5. Clean dust and impurities blocking the product's air intake to prevent a decrease in airflow.
6. When not using this product for a long time, please cover the top air outlet grille to prevent dust from entering and keep the outlet grille and internal fan blades clean.
7. If the product is abnormal, such as abnormal noise, odor, high temperature, or irregular fan rotation, please stop using it immediately.
8. Do not place hair, fabric, etc. close to the product to avoid entangling or blocking the air inlet hole and the air outlet grille.

10. Do not pour liquid, powder, debris, or fine matter into the product from the outlet grille.
11. Avoid excessive pulling, twisting, or bending of the power cord to prevent exposed wires or breakage.
12. Do not attempt to disassemble or repair the product by yourself. For any questions and concerns, please contact the after-sale support team and manufacturer at [support@tdbywae.com](mailto:support@tdbywae.com).
9. When using the product simultaneously with household gas appliances (such as gas stoves and water heaters), please ensure proper ventilation to prevent carbon monoxide poisoning.

## Maintenance

1. Do not spray water on the product and Do not splash water onto the filter.
2. Do not use it on watery floors or in humid environments such as bathrooms to avoid the risk of electric shock.
3. External Cleaning: Wipe the product's body with a soft damp cloth. Do not use strong solvents or detergents as they may damage the surface coating.
4. Internal Cleaning: Clean the interior with a soft damp cloth.
5. Replace the filter every 2-4 months. It varies depending on the area and ambient air quality. The filter replacement cycle may be reduced in heavily polluted areas, smoking areas, etc. When the filtering effect is poor, please replace the filter.
6. Especially the air intake, ensure the product is kept away from open flames and devices such as candle holders, incense burners, stoves, fireplaces, lighters, igniters, and fire bowls.
7. Keep the product away from high-temperature heating appliances such as electric heaters, space heaters, electric stoves, and irons.



## Troubleshooting

Problems	Possible Reasons and Solutions
<b>Fail to start</b>	<ol style="list-style-type: none"> <li>1. Check if the charging cable plug is electrified.</li> <li>2. Check if the charging cable plug is loose.</li> </ol>
<b>Low air output</b>	<ol style="list-style-type: none"> <li>1. Check if there are any obstructions in the outlet grille or air intake. If so, please turn off the air purifier and remove the obstructions.</li> <li>2. Check if the filter has been used for a long time and become dirty. If so, please try to replace a new filter.</li> </ol>
<b>Can't feel the effect</b>	<ol style="list-style-type: none"> <li>1. Please check that the filter element is installed correctly.</li> <li>2. The filter is too dirty and has not been replaced for a long time. Please replace the filter.</li> </ol>
<b>The air purifier produces a strange smell.</b>	<ol style="list-style-type: none"> <li>1. The filter is too dirty and has not been replaced for a long time. Please replace the filter.</li> <li>2. Water has entered the filter or the purifier has been used in a humid environment. Please replace the filter.</li> <li>3. Reuse the purifier that has been stopped use or sealed for a long time. Please clean the filter first. If this cannot be solved, please replace the filter.</li> <li>4. Keep the product away from high-temperature heating appliances.</li> <li>5. If there is a burning smell. Stop using it immediately, unplug the power supply, and contact the customer support team for help.</li> </ol>

# TDBYWAE

## Air Purifier

MB-032



EPA Est. No.: 102632-CHN-1

MADE IN CHINA